

# CORRECTIONS FOR CATALOGUE

The following corrections are for misprints that have been found in the 2010-2011 Catalogue for Car Audio & Multimedia. We sincerely regret any confusion or inconvenience they may have caused.

## ■ P07 / VX709A Full system example

The photos and placement of XR2110 (amplifier) and SRP1721S (speakers) were incorrect, as well as the model name.

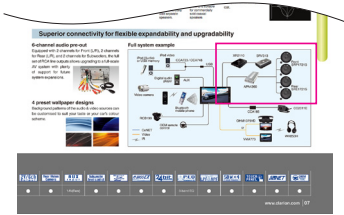

<Incorrect>



<Corrected>

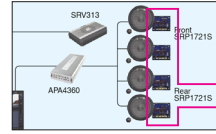

- XR2110 was removed
- Model name was incorrect, therefore corrected to SRP1721S. Photos of Crossover Network were added.

## ■ P11 / VZ509A System-up example

The placement of APA4360 and APA2180 (amplifiers) was incorrect.

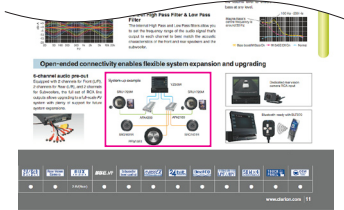

<Incorrect>

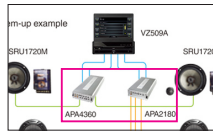

(Left) APA4360  
(Right) APA2180

<Corrected>

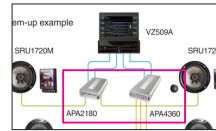

(Left) APA2180  
(Right) APA4360

## ■ P15 / VB476 System-up example

Photos of SRP1721S (speakers) Crossover Network were missing.



<Incorrect>

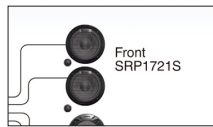

<Corrected>

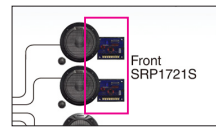

- Photos of Crossover Network were added.

## ■ P37 / SPEAKERS SUPERB SOUND SERIES

Product photos for SRQ Series (SRQ1621S) and SRE Series (SRE1721S) were incorrect.



<Incorrect>



(Left) SRE1721S  
(Right) SRQ1621S

<Corrected>



(Left) SRQ1621S  
(Right) SRE1721S